



*Work, rest and play,
perfectly balanced*



Highwoods Green

Great connectivity

- 11 miles to the city of Derby
- Join the A42 and M1 in five miles
- Three miles to East Midlands Airport
- Proximity to HS2 for future high speed rail links

**** DEPOSIT CONTRIBUTION ****

HIGHWOODS VALE IS AN EXCLUSIVE
DEVELOPMENT OF JUST 6 PLOTS ****

Abode are delighted to be able to offer
for sale THE ALLFORD. Perfect two
bedroom semi detached home offering
a hall with guest cloakroom, high
specification fitted kitchen and a
lounge with doors onto the garden. Two
bedrooms and a bathroom on the first
floor. Enclosed garden, and a drive,
solar PV panels, Air source heat pump,
Underfloor heating. CONTACT ABODE
01332 331010 for more information.

READY OCTOBER



Calke Abbey

Life becomes a great adventure

Beyond the calm of your home, endless opportunities for adventure beckon. With access to both rambling countryside and Staunton Harold Reservoir for fishing and sailing, **the great outdoors is on your doorstep to explore.** Or peruse the local farm shops of nearby Melbourne, visit the National Trust's Calke Abbey and soak up the open-air markets and historical attractions of Ashby-de-la-Zouch. And at the end of a day of exploring, **you can look forward to a cosy evening back at home.**

Enjoy nearby attractions

- Five minutes to the bustling market town of Melbourne
- Ten minutes to the Priory Health Club with gym, pool and fitness classes
- Six miles to Donington Park Circuit
- Five miles to the local restaurants and historical attractions of Ashby-de-la-Zouch

Where real life happens

Our homes are designed around people, not plans. Highwoods Vale has a range of homes to suit your lifestyle, from more space for growing families to a cosy place to downsize.

With mindful design and flexible layouts, from open-plan living, second en suites, and ample parking for multiple vehicles, your Cameron home will grow and adapt with you and your family.



INFORMATION

What's included -

KITCHEN FINISHINGS

British designed and manufactured kitchen
Premium Bosch and Electrolux appliances*
Downlighters to kitchen
Your choice of kitchen finishes
Bathroom finishings

Ideal Standard sanitaryware
Porcelanosa wall tiling to the bathroom, master en suite and cloakroom as standard
Porcelanosa floor tiling to the bathroom*, master en suite* and cloakroom*
Flow restrictors to showers
Vanity units to master en suite
Interior finishings

Panel grained cottage style doors
Ovolo moulding skirting and architrave
Ash/Oak handrail to staircase
Compact style radiators with TRVs
Built in wardrobe to master bedroom with sliding doors*
Electrical and lighting

Downlight with PIR to front and rear
Hive Heating & Hot Water Thermostat
Hive mini hubless thermostat – secondary source
Electric in-wall toothbrush charger to master en suite*
Hagar USB power sockets*
Media Plate and TV point installed
Ring wired doorbell*
Outside tap*
Exterior finishings

Slabs to rear of plot
Turf to front
PV Panels
PVCu double glazed windows
Electric vehicle chargers
Energy-Saving features
Photo voltaic "solar" panels
Flow restrictors to showers
Hive heating and hot water thermostat
Electrical vehicle (EV) chargers
Enhanced insulation of walls, roof and ceilings for reduced energy bills and more
Battery storage*
Air Source Heat Pump
Underfloor heating
Peace of mind

Two year fixtures and fittings warranty with Cameron Homes
Ten year NHBC warranty on the structure of your home
All homes built to the New Homes Quality Code standard
*Optional extra

PLEASE NOTE



Homes with heart
and heritage

* Photographs and virtual tours maybe a version of a Heritage from another site.
* Incentives are subject to T&C's
* Management/service charges per plot £312.68 per annum

Alford
2 BEDROOM HOME
Plots 56, 57

- 2
- 1
- 753 sqft
- Energy-efficient home
- 2 spaces

Core characteristics	
Living room with French doors onto rear garden	Two double bedrooms
Downstairs WC	Air Source Heat Pump
Solar PV panels	Underfloor heating





Highwoods Green



Melbourn Hall

A connected, countryside community

At Highwoods Vale, panoramic views and lush countryside become the backdrop for your everyday life. Perched on a hill five miles north of Ashby-de-la-Zouch, Highwoods Vale has all the charm of a small countryside community with its rolling landscapes, village green, well-respected primary school and choice of two local pubs. And when you need to venture further afield, easy access to local transport connections ensures it's an easy commute.

Top-rated schools

- St Hardulph's Church of England Primary
- Loughborough Grammar School
- Loughborough High School
- Ashby School
- Ivanhoe College
- Castle Donington College
- Chellaston Academy



Flexible living for every lifestyle

Surrounded by open countryside, whether you choose a two, three or five-bedroom home, you'll enjoy a unique sense of space - both inside and out. Carefully **considered site design and floorplans** that give you the freedom to **customise your home**. Whether that's a quiet area to retreat to with a book, a garden where your children can play, or an open-plan kitchen where everyone can gather.



Highwoods Green

A quiet and
characterful cul-de-sac

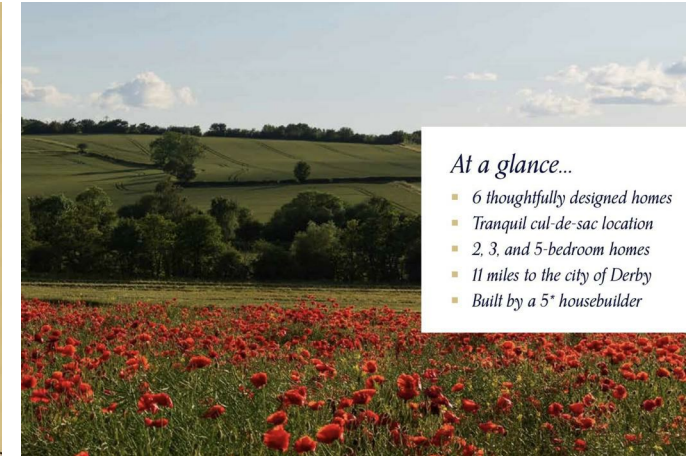

At a glance...

- 6 thoughtfully designed homes
- Tranquil cul-de-sac location
- 2, 3, and 5-bedroom homes
- 11 miles to the city of Derby
- Built by a 5* housebuilder





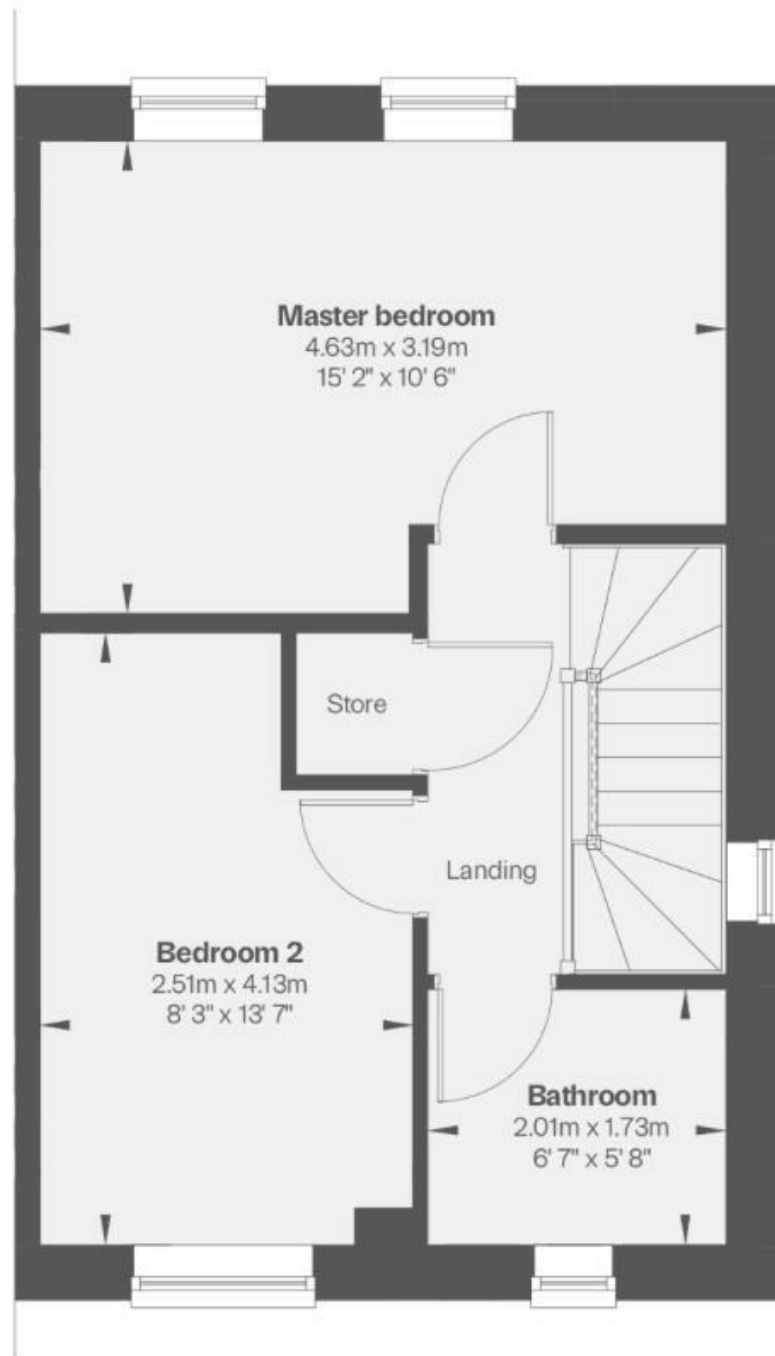

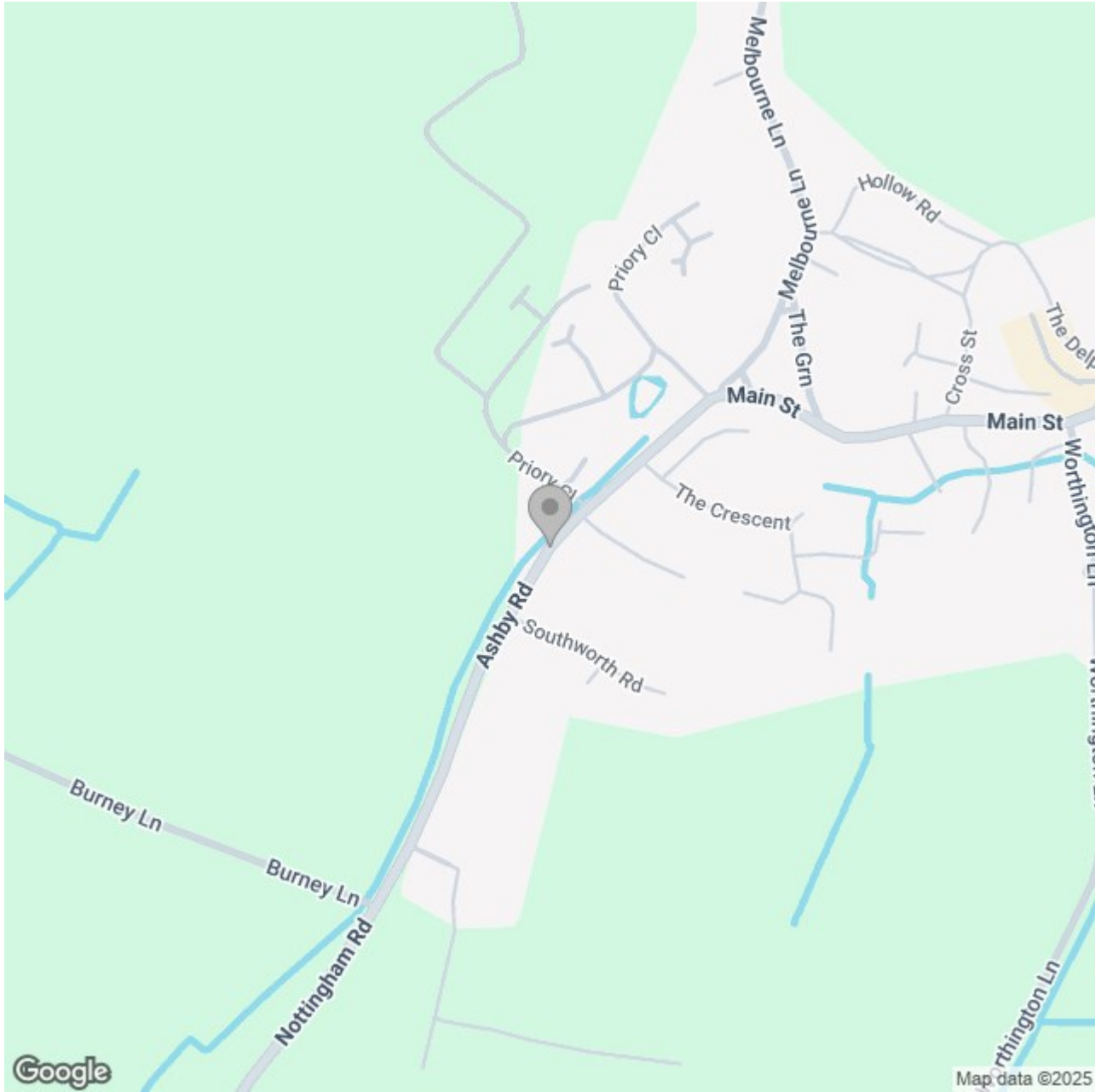

Energy Efficiency Rating

	Current	Potential
Very energy efficient - lower running costs		
(92 plus) A		
(81-91) B		
(69-80) C		
(55-68) D		
(39-54) E		
(21-38) F		
(1-20) G		
Not energy efficient - higher running costs		

England & Wales

EU Directive 2002/91/EC

