





**** PERIOD PROPERTY **** PLENTY OF
POTENTIAL **** FOUR BEDROOMS &
TWO SHOWER ROOMS **** Ideal HMO
or investemnet in a popular location of
the edge of Derby City Centre. Hall,
Lounge, dining room or bedroom 4 &
dining kitchen. Three bedrooms and two
shower rooms on the first floor. Enclosed
rear garden. SOLD WITH NO UPWARD
CHAIN.



HALL

Entrance door into the hall with stairs to the first floor, under stairs storage cupboard, and doors to -

LOUNGE

Window to the front.

DINING ROOM/BEDROOM 4

Window to the rear.

DINING KITCHEN

Fitted units with work surfaces and a sink and drainer unit. Window and door to the garden.

FIRST FLOOR LANDING

Doors to -

BEDROOM

Window to the front.

BEDROOM

Window to the rear.

BEDROOM

Window to the rear.

SHOWER ROOM

Wc, wash hand basin, shower, window to the front. .

SHOWER ROOM

Shower and wash hand basin.

OUTSIDE

Enclosed rear garden with lawn and a rear gate.



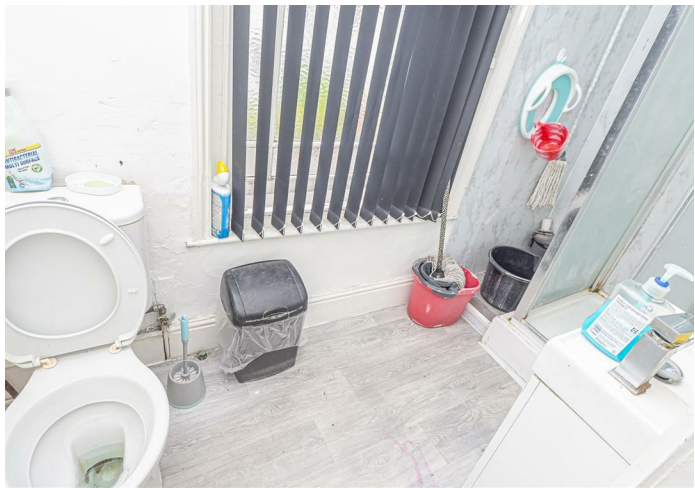

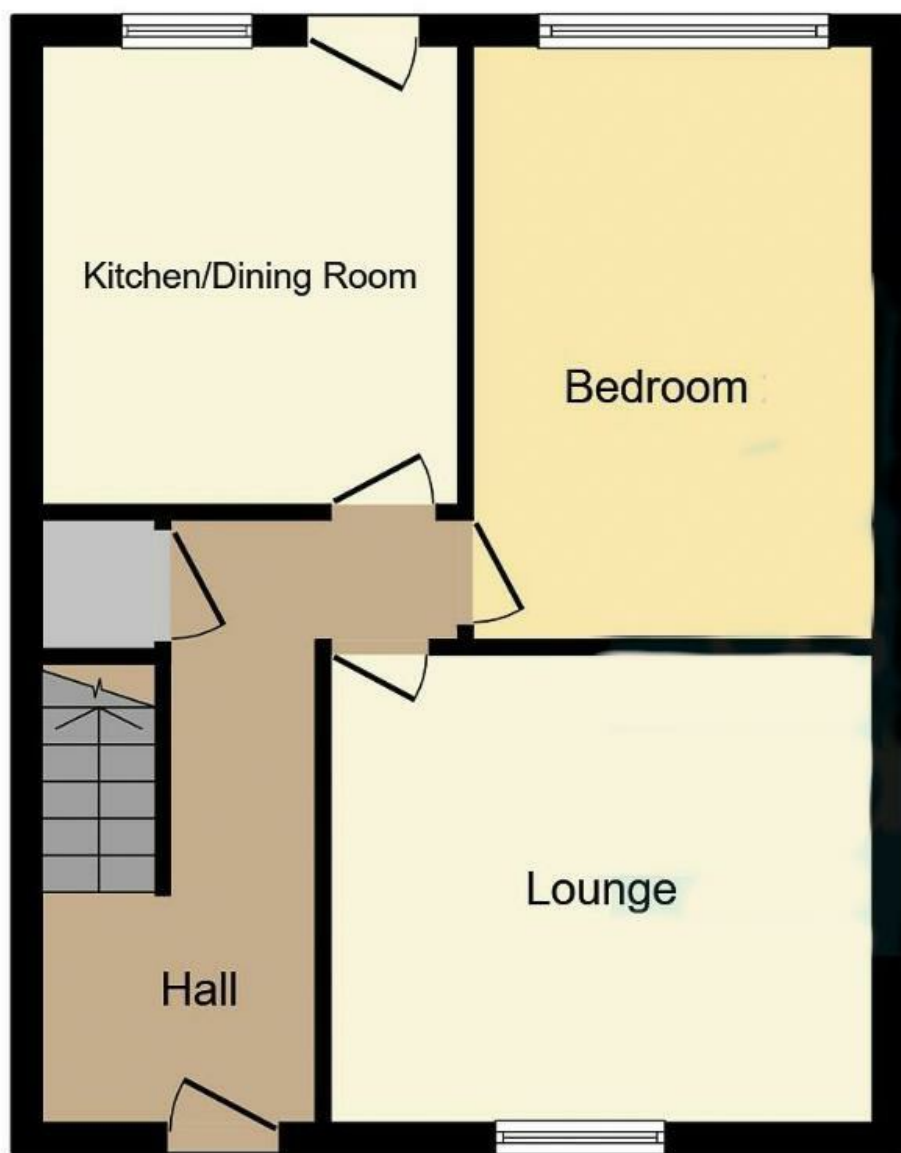

Ground Floor

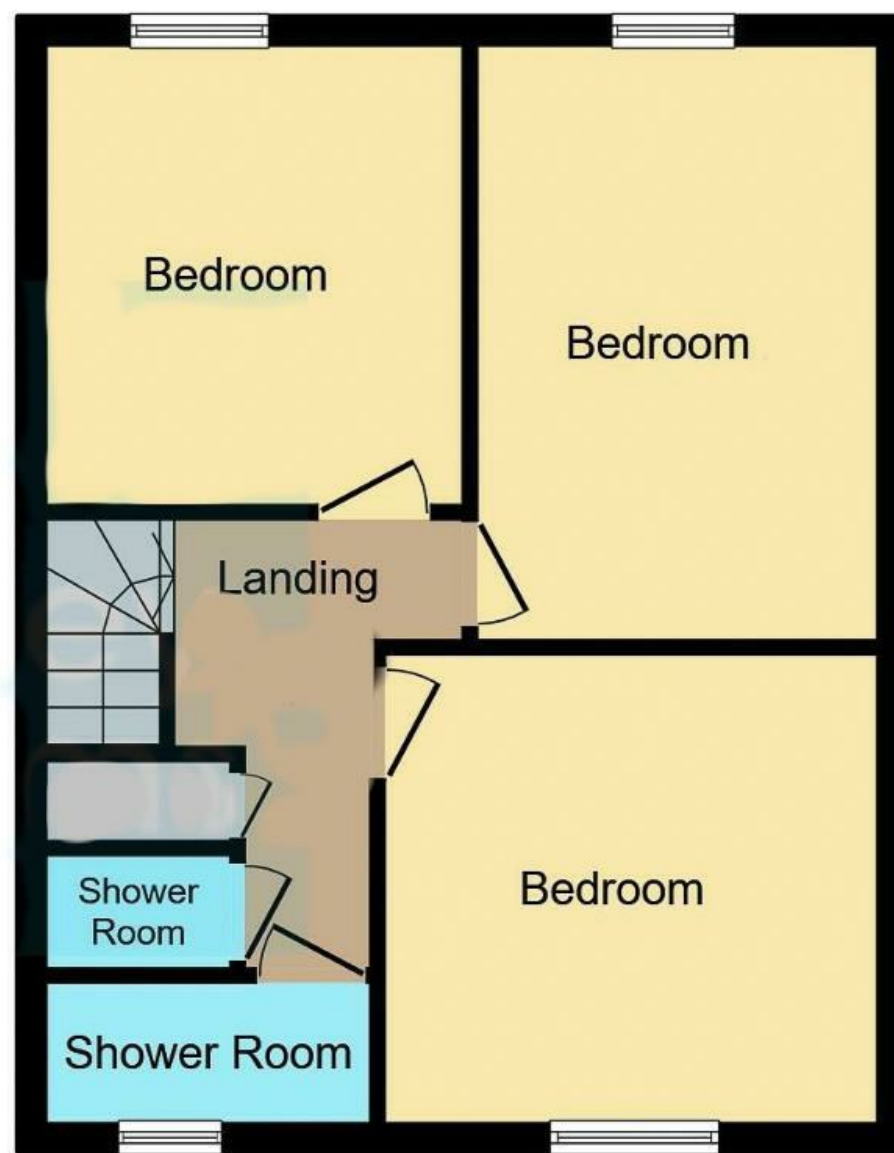

First Floor

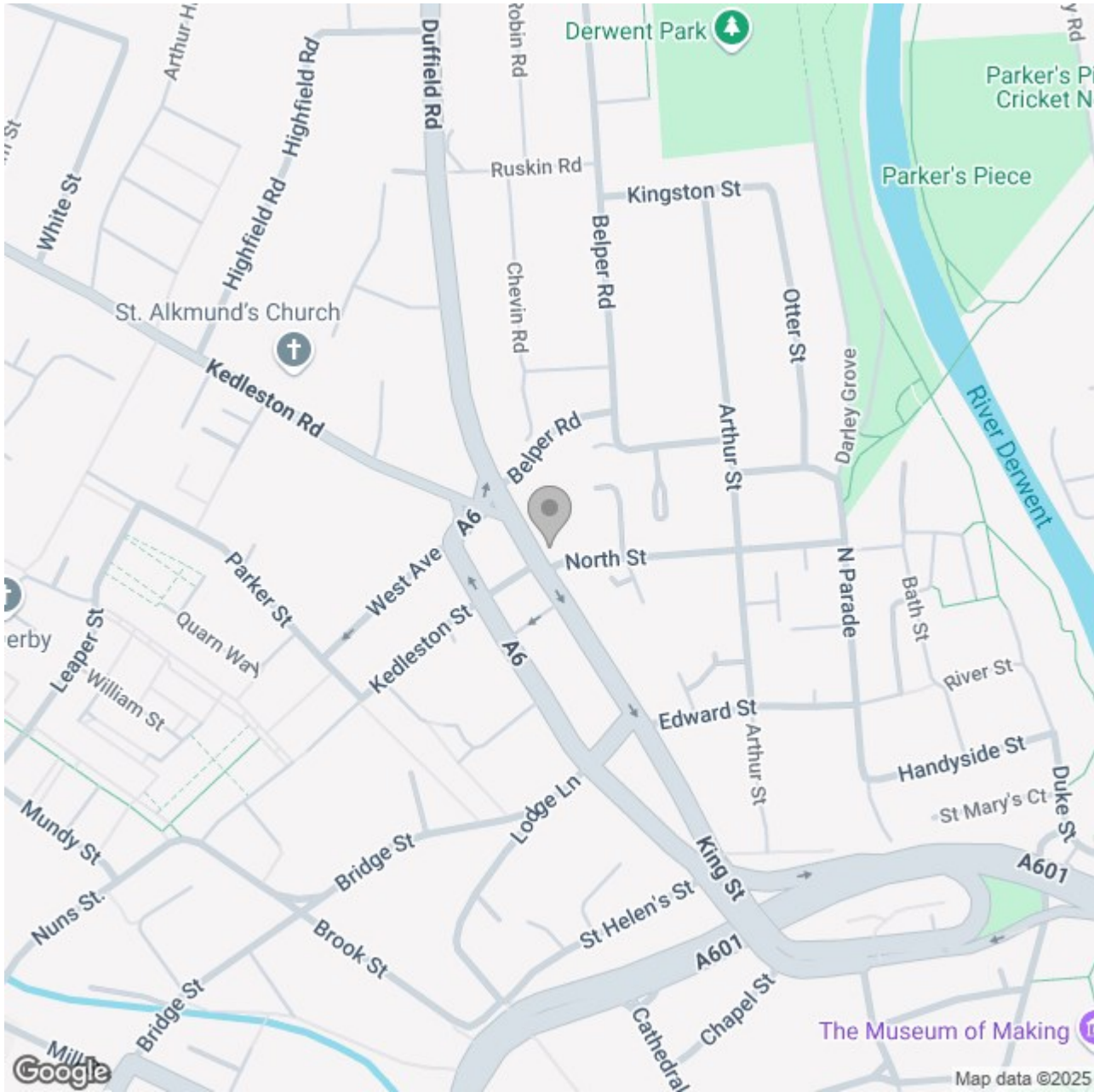

Energy Efficiency Rating

	Current	Potential
Very energy efficient - lower running costs		
(92 plus) A		87
(81-91) B		
(69-80) C	70	
(55-68) D		
(39-54) E		
(21-38) F		
(1-20) G		
Not energy efficient - higher running costs		

England & Wales

EU Directive 2002/91/EC