





**** 75% SHARED OWNERSHIP ****
 MODERN FOUR BEDROOM DETACHED
 PROPERTY **** MASTER BEDROOM
 WITH DRESSING AREA AND EN SUITE
 **** Perfect and well proportioned
 home offering a hall with guest
 cloakroom, lounge with doors into the
 garden and a fitted dining kitchen. Four
 good size bedrooms, master with fitted
 wardrobes and an en suite shower
 room, family bathroom. Long drive and
 a single garage, enclosed rear garden.
 Located in the popular village of Linton
 offering access to a full range of local
 amities, schooling and close to
 countryside walks. Linton also offers a
 great road network. INTERNAL VIEWING
 IS HIGHLY RECOMMENDED.



HALL

Entrance door into the hall with stairs to the first floor, radiator, storage cupboard and doors to -

CLOAKROOM

Low flush wc, wash hand basin, radiator and upvc double glazed window.

KITCHEN DINER

Fitted wall mounted, base and drawer units with work surfaces and a sink and drainer unit. Fitted electric oven with has hob and extractor, integrated fridge freezer, dishwasher and plumbing and space for a washing machine. Radiator, upvc double glazed window to the front and a radiator.

LOUNGE

Upvc double glazed window to the side and doors onto the garden, radiator.

FIRST FLOOR LANDING

Upvc double glazed window to side, airing cupboard and doors to -

BEDROOM

Upvc double glazed window and a radiator.

BEDROOM

Upvc double glazed window and a radiator.

BEDROOM

Upvc double glazed window and a radiator.

BATHROOM

Paneled closed bath, wash hand basin, low flush wc, radiator and upvc double glazed window.

SECOND FLOOR

Door to -



MASTER BEDROOM

Fitted wardrobes, radiator, upvc double glazed window and door to -

EN SUITE

Enclosed shower, wash hand basin, low flush wc, radiator and a sky light window.







OUTSIDE

There is a long side drive, wide enough for a caravan and for up to 3 cars. Single garage with up and over door. Gated access to the enclosed rear garden offering a paved seating area, lawn and a based base for greenhouse or shed.

NOTE

The rent and admin fees to Heylo come to £268 per month.









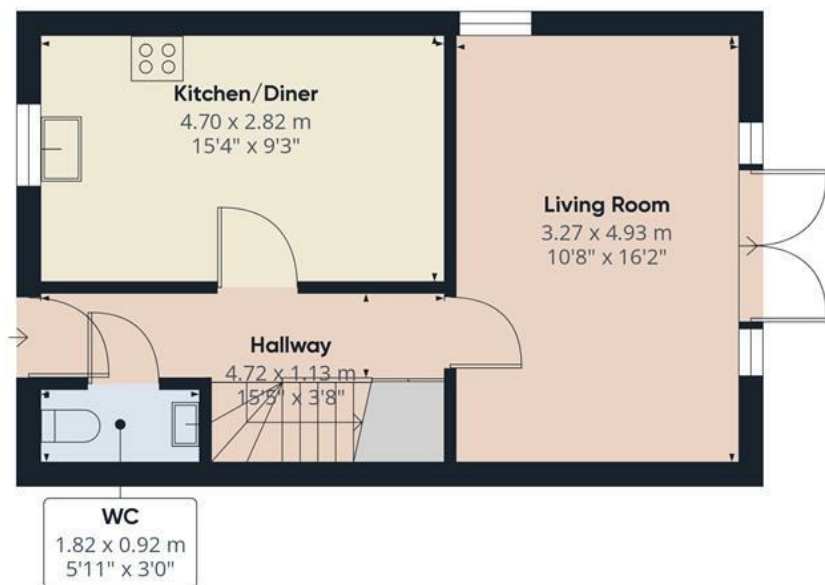

Floor 0



Floor 1



Floor 2



Approximate total area⁽¹⁾

98.79 m²
1063.38 ft²

Reduced headroom

1.47 m²
15.83 ft²

(1) Excluding balconies and terraces

Reduced headroom

..... Below 1.5 m/5 ft

While every attempt has been made to ensure accuracy, all measurements are approximate, not to scale. This floor plan is for illustrative purposes only.

Calculations are based on RICS IPMS 3C standard.

GIRAFFE360

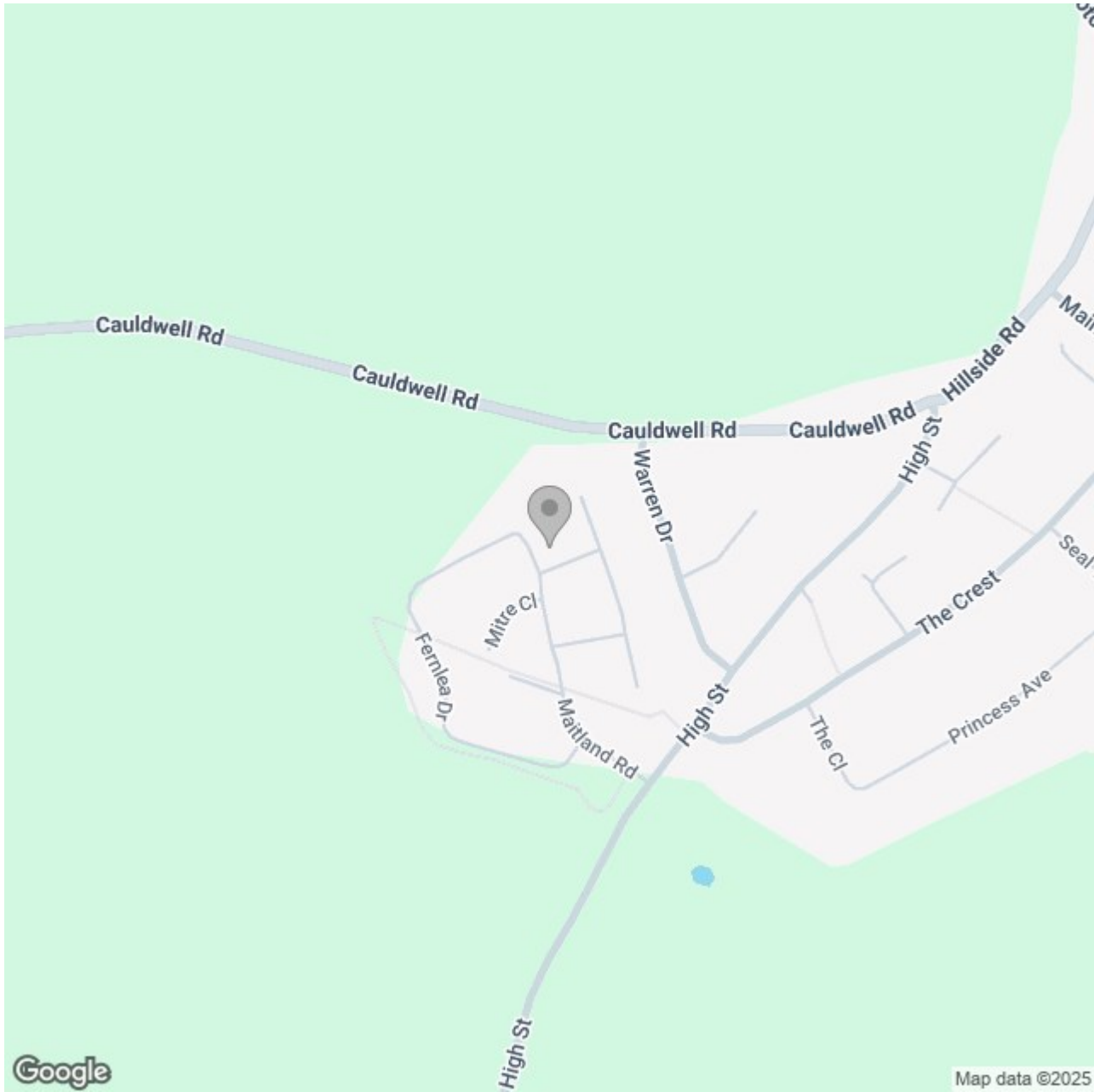

Energy Efficiency Rating

	Current	Potential
Very energy efficient - lower running costs		
(92 plus) A		93
(81-91) B	83	
(69-80) C		
(55-68) D		
(39-54) E		
(21-38) F		
(1-20) G		
Not energy efficient - higher running costs		

England & Wales

EU Directive 2002/91/EC