





A well presented two bedroom townhouse situated on the edge of Stretton and Burton Upon Trent town centre.

Well presented throughout, this is a rare opportunity to secure a two bedroom house in a much sought after location which offers superb local amenities including leisure activities and road links.

In brief, the accommodation provides - good sized kitchen/diner with a great selection of wall and base units and separate living room.

The first floor provides two well proportioned bedrooms and bathroom with shower over the bath.

A good sized garden surrounds the property with lawn and established borders to rear and driveway to frontage.



ABODE
SALES & LETTINGS





Ground Floor

Approx. 27.1 sq. metres (292.2 sq. feet)

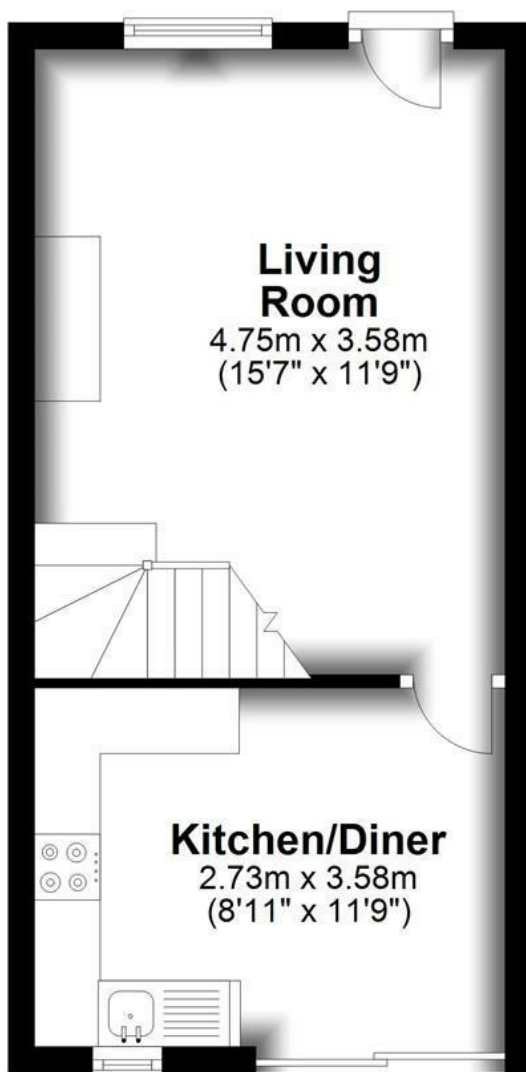

First Floor

Approx. 27.2 sq. metres (292.9 sq. feet)

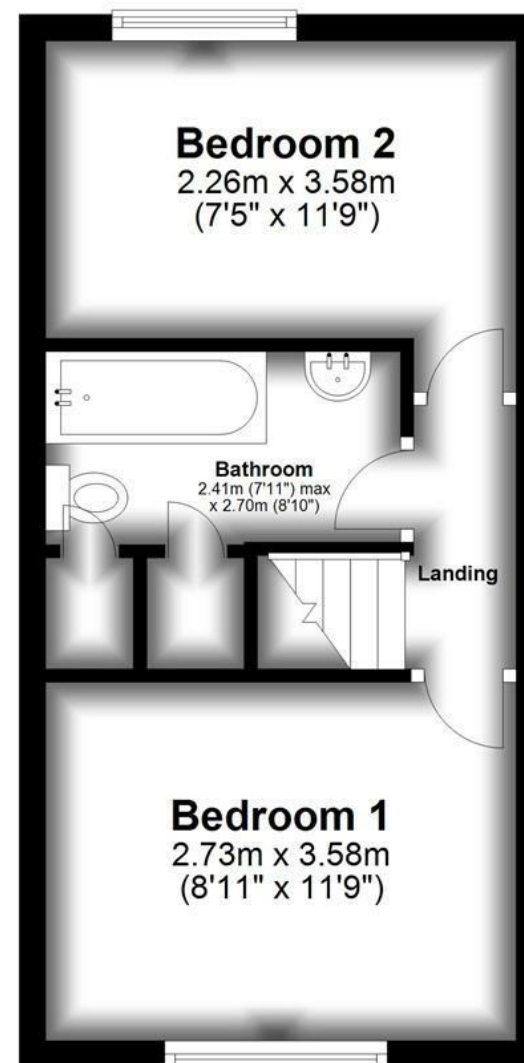

Total area: approx. 54.4 sq. metres (585.1 sq. feet)

Please use as a guide to layout only. They are not intended to be to scale. Property of Abode Anderson-Dixon.
Burton-Uttoxetter-Ashbourne
Plan produced using PlanUp.

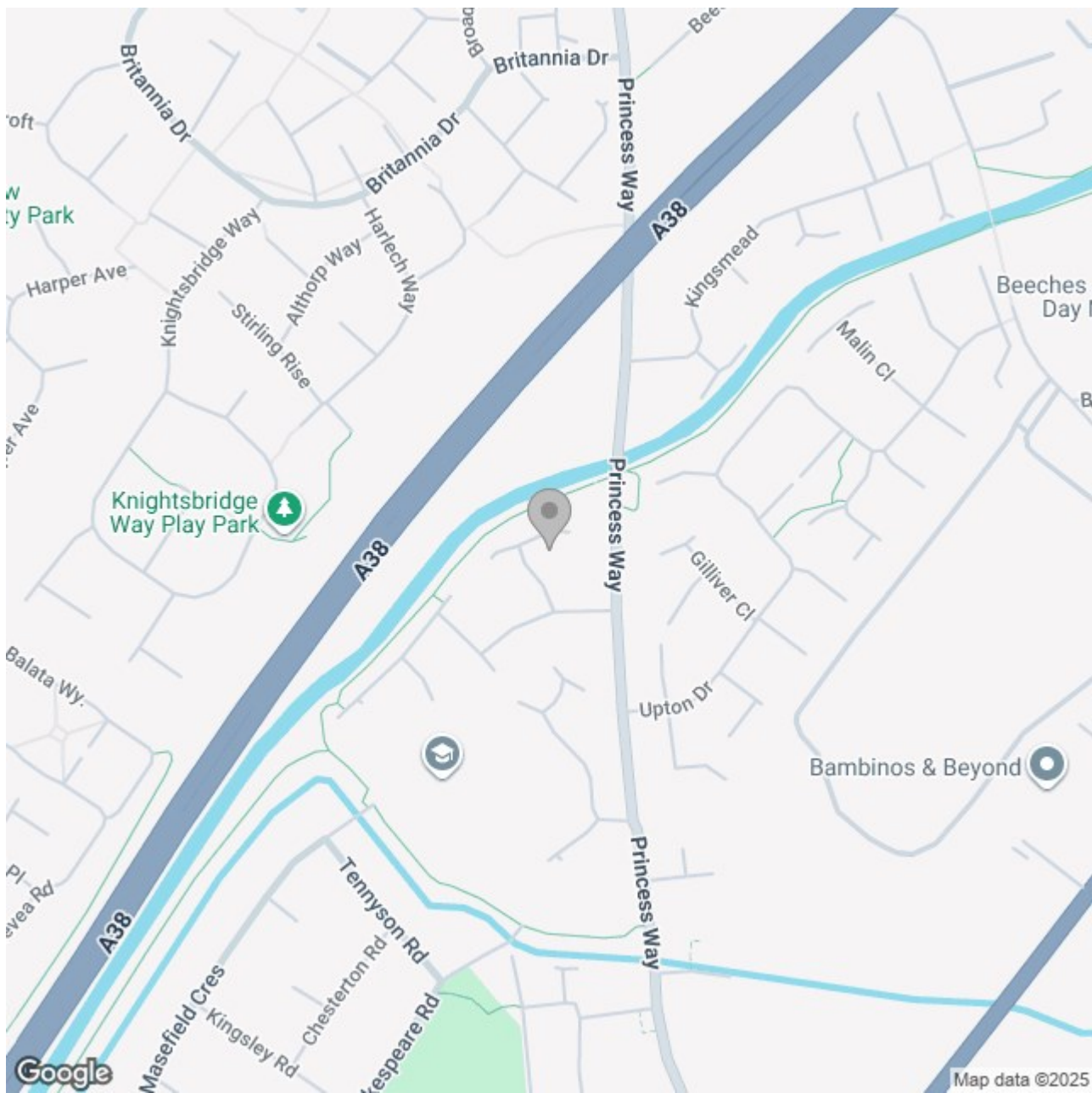

Energy Efficiency Rating

	Current	Potential
Very energy efficient - lower running costs		
(92 plus) A		
(81-91) B		86
(69-80) C	70	
(55-68) D		
(39-54) E		
(21-38) F		
(1-20) G		
Not energy efficient - higher running costs		

England & Wales

EU Directive 2002/91/EC