





**** MODERN PROPERTY PERFECT FOR A
FIRST TIME BUYER OR INVESTMENT,
SOLD WITH NO UPWARD CHAIN ****
Semi detached property, fitted kitchen,
lounge and guest cloakroom, two
bedrooms, bathroom. Drive and a
garden.



KITCHEN DINER

Fitted wall. mounted, base and drawer units with works surfaces and a sink unit. Fitted oven and hob, integrated fridge freezer, plumbing and space for a washing machine, radiator, door to the cloakroom.

CLOAKROOM

Low flush wc, wash hand basin and radiator.

INNER LOBBY

Stairs to the first floor.

LOUNGE

Upvc double glazed door and window onto the garden, radiator.

FIRST FLOOR LANDING

Doors to -

BEDROOM 1

Upvc double glazed window and radiator.

BEDROOM 2

Upvc double glazed window and radiator.

BATHROOM

Panel enclosed bath with a shower and shower screen, wash hand basin, low flush wc, radiator and a upvc double glazed window.

OUTSIDE

Front drive and an enclosed rear garden.





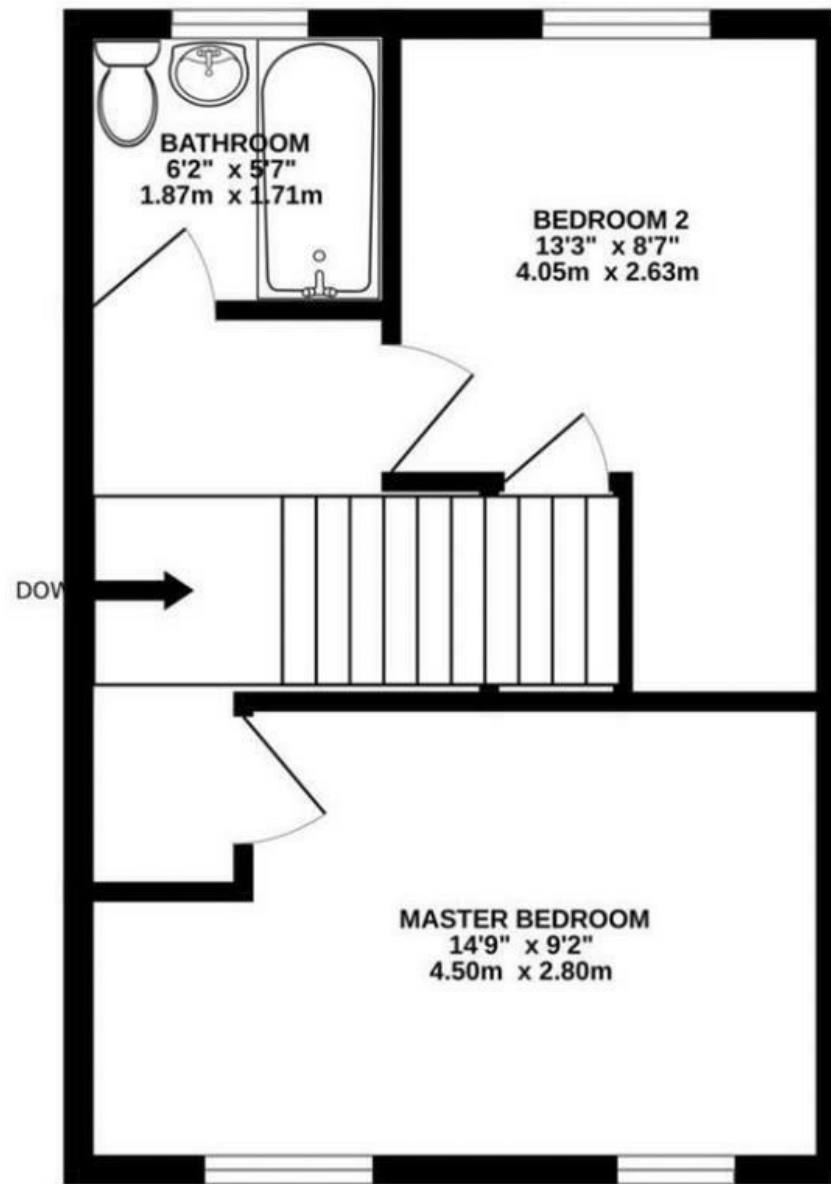
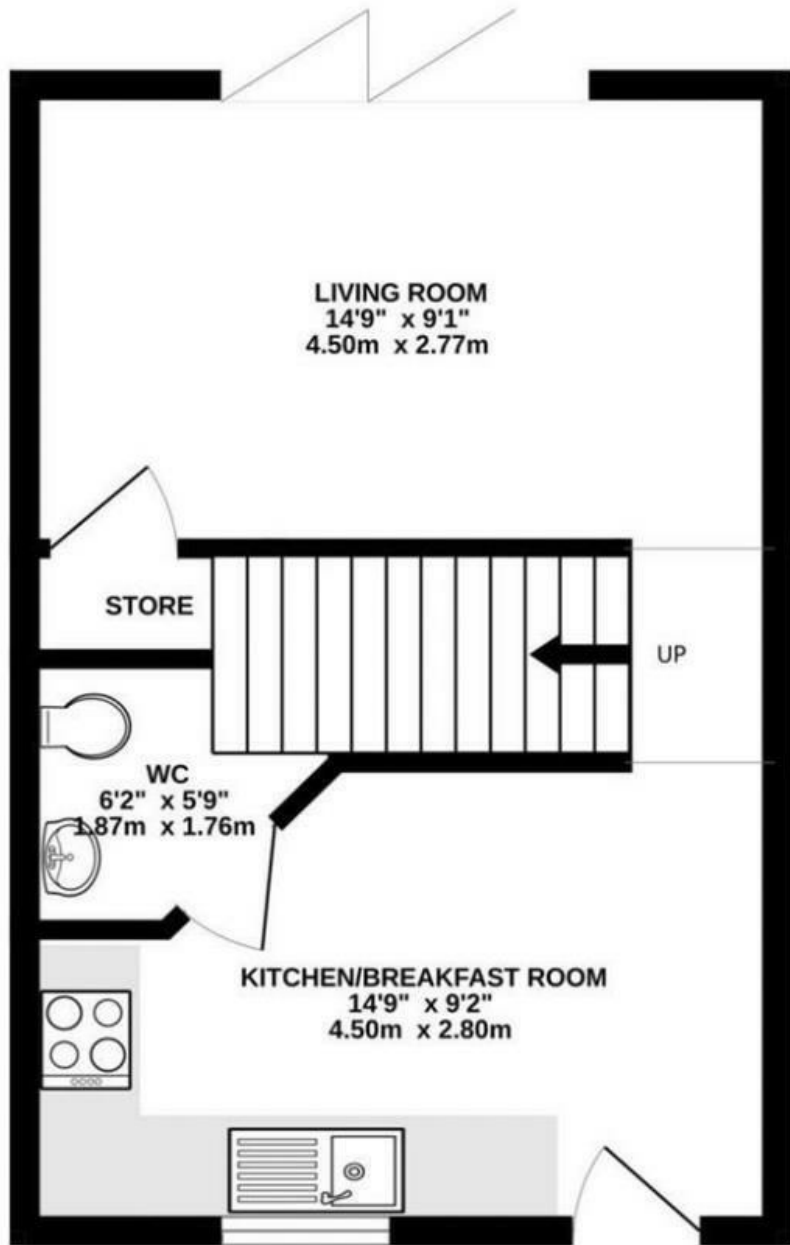

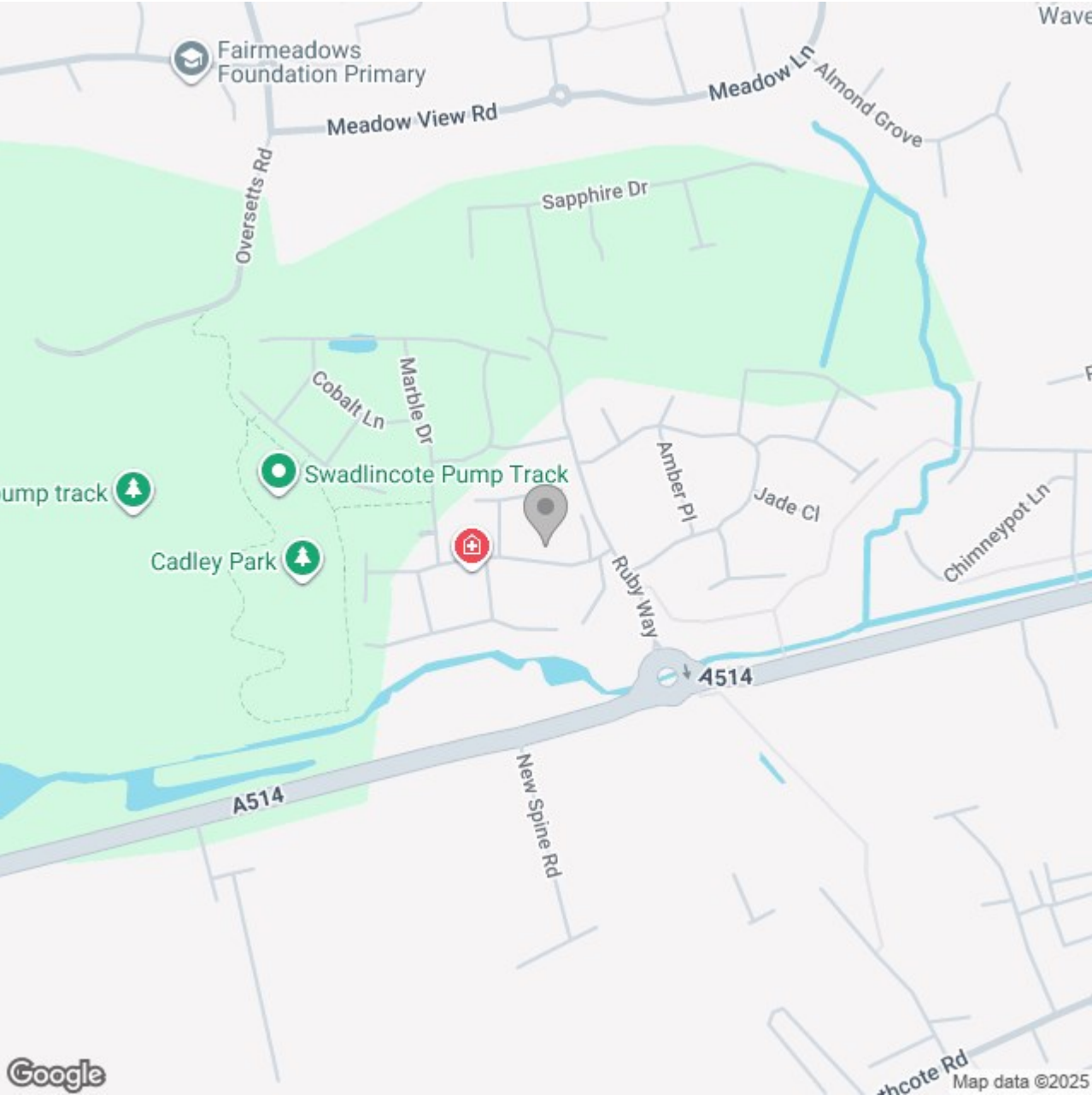

Energy Efficiency Rating

	Current	Potential
Very energy efficient - lower running costs		
(92 plus) A		97
(81-91) B	84	
(69-80) C		
(55-68) D		
(39-54) E		
(21-38) F		
(1-20) G		
Not energy efficient - higher running costs		

England & Wales

EU Directive 2002/91/EC