





MODERN PROPERTY IN  
POPULAR LOCATION  
OFFERING A HALL,  
GUEST CLOAKROOM,  
KITCHEN DINER,  
LOUNGE, TWO DOUBLE  
BEDROOMS, EN SUITE  
SHOWER ROOM AND  
BATHROOM. PARKING  
AND GARDEN. NO  
CHAIN.



## HALL

Entrance door into the hall with radiator, stairs to the first floor and doors to -

## CLOAKROOM

Low flush wc, wash hand basin, radiator.

## KITCHEN DINER

8'7" x 15'1"

Fitted units with work surfaces and a sink and drainer unit.

## LOUNGE

16'0" x 10'11"

Window and doors onto the garden.

## FIRST FLOOR LANDING

Doors to -

## BEDROOM 1

2.7m x 4.14m

Window, radiator and door to the en suite.

## EN SUITE

Shower, low flush wc, wash. hand basin, radiator and window.

## BEDROOM 2

8'10" x 12'4"

Window and radiator.

## BATHROOM

Bath, low flush wc, wash hand basin, radiator and window.

## OUSIDE

Rear parking and garden.





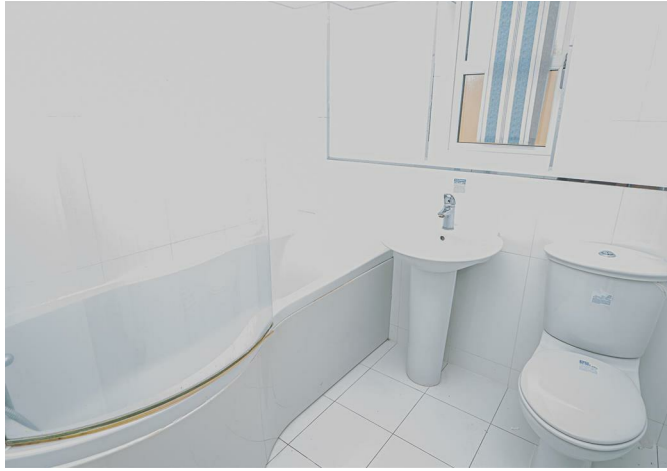

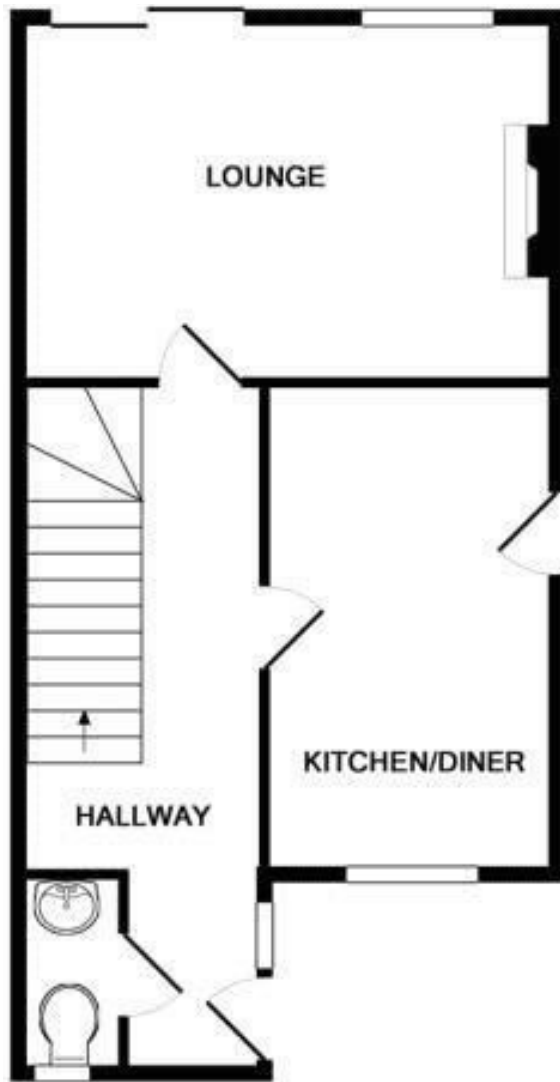

GROUND FLOOR

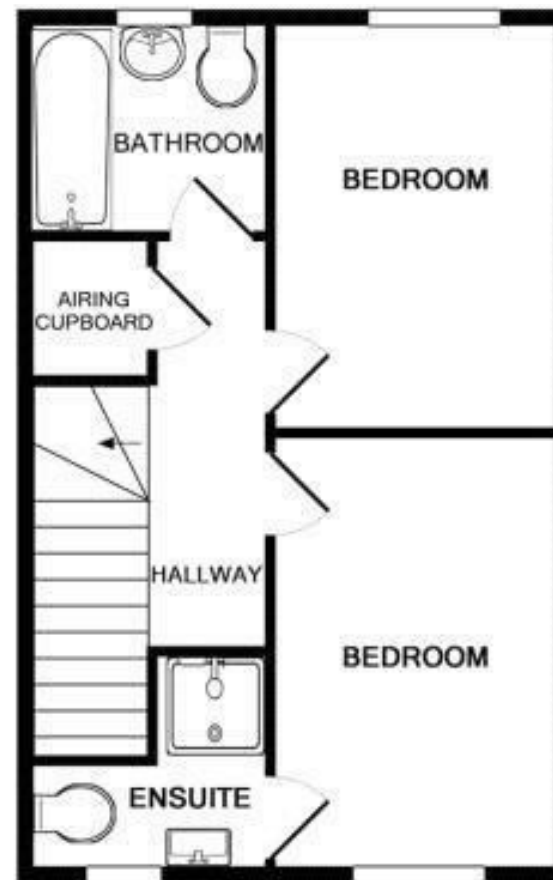

1ST FLOOR

Whilst every attempt has been made to ensure the accuracy of the floor plan contained here, measurements of doors, windows, rooms and any other items are approximate and no responsibility is taken for any error, omission, or mis-statement. This plan is for illustrative purposes only and should be used as such by any prospective purchaser. The services, systems and appliances shown have not been tested and no guarantee as to their operability or efficiency can be given  
 Made with Metropix ©2017

