





**** LARGE TIMBER WORKSHOP INCLUDED IN THE SALE ****
Perfect modern semi detached property benefitting from upvc double glazed windows and a gas heating system. In brief the property offers a hall, lounge and fitted kitchen, two bedrooms and a bathroom, off road parking and a single garage. Enclosed rear garden with a workshop with power and lights. EARLY VIEWING IS HIGHLY RECOMMENDED.



HALL

Entrance door into the hall with arch to -

LOUNGE

14'1 x 11'8

Upvc double glazed window to the front, stairs to the first floor radiator and a Brock fireplace.

KITCHEN

11'9 x 7'7

Fitted wall mounted, base and drawer units with work surfaces and a sink and drainer unit. Plumbing and space for a washing machine, space for a cooker and other appliances. Breakfast bar, upvc double glazed window to the rear and a door onto the garden, radiator.

FIRST FLOOR LANDING

Loft access and doors to -

BEDROOM 1

11'8 x 8'7

Fitted wardrobes, cupboards and drawers, upvc double glazed window and a radiator.

BEDROOM 2

8'5 x 6'9

Built in cupboard, radiator and upvc double glazed window.



BATHROOM

6'4 x 5'4

Panel enclosed bath with an electric shower over, wash hand basin and a low flush wc. Upvc double glazed window and a radiator.

OUTSIDE

Ample parking to the front and in front of the single garage. Enclosed rear garden with paved and slate seating areas and included in the sale is a large timber workshop/cabin with lights and power.







GROUND FLOOR

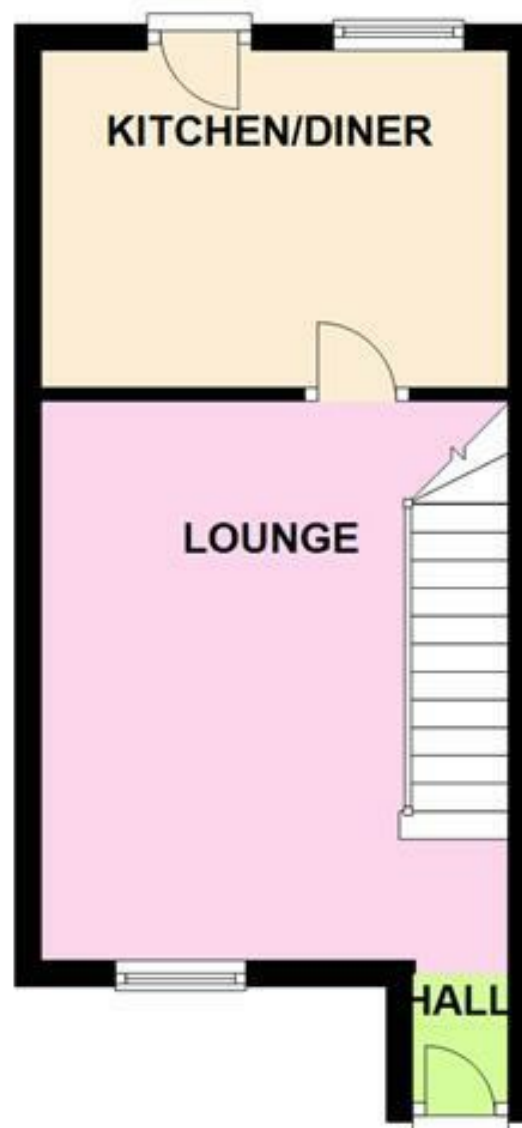

Please use as a guide to layout only. They are not intended to be to scale. Property of Abode Anderson-Dixon. Burton-Uttoxetter-Ashbourne
Plan produced using PlanUp.

FIRST FLOOR



