







\*\*\*\* 0.9 ACRE Paddock  
WITH 2 STABLES AND 2  
OUTBUILDINGS \*\*\*\*  
DETACHED PROPERTY WITH  
FOUR DOUBLE BEDROOMS  
\*\*\*\* Abode are delighted to  
bring to the market to  
versatile home in the highly  
regards village of  
Forsbrook. The property  
offers an entrance hallway,  
lounge with log burner,  
fitted dining kitchen and a  
good size conservatory. Four  
double bedrooms and a  
shower room. Off road  
parking and gardens.



**ABODE**  
SALES & LETTINGS



### ENTRANCE HALL

Good size space with a tiled floor, stairs to the first floor and doors to -

### LOUNGE

13'8 x 11'11

Feature wood burning stove, radiator and upvc double glazed window.

### DINING KITCHEN

13'9 x 12'11

Fitted wall mounted, base and drawer units with work surfaces and a sink and drainer unit. Fitted electric double oven with gas hob and an extractor hood, plumbing and space for a dishwasher, radiator and a tiled floor.

### CONSERVATORY

13'11 x 11'10

Brick and double glazed windows, tiled floor, radiator and door into the rear garden.

### UTILITY ROOM

Plumbing and space for a washing machine, tiled floor and a door to the side.

### BEDROOM 3

12'11 x 10'10

Upvc double glazed window and a radiator.

### BEDROOM 4

10'1 x 10'0

Upvc double glazed window and a radiator. Wardrobe's.



### SHOWER ROOM

Large walk-in shower, bowl flush wc, wash hand basin, radiator and upvc double glazed window.

### FIRST FLOOR LANDING

Oak flooring and velux window.

### BEDROOM 1

13'4 x 7'7 (to eaves)

Oak flooring and two velux windows.











## BEDROOM 2

10'6 x 7'3 (to eaves)

Oak flooring and two velux windows.

## OUTSIDE

Front garden and a sweeping drive to the side and front. Gates through to more parking and access to the rear garden and paddock.

The rear garden offers seating areas and a lawn with mature plants and shrubs.

There are two stables, a covered store, brick storage shed and garage/hay barn along with hardstanding at the rear of the property with an enclosed paddock.















GROUND FLOOR

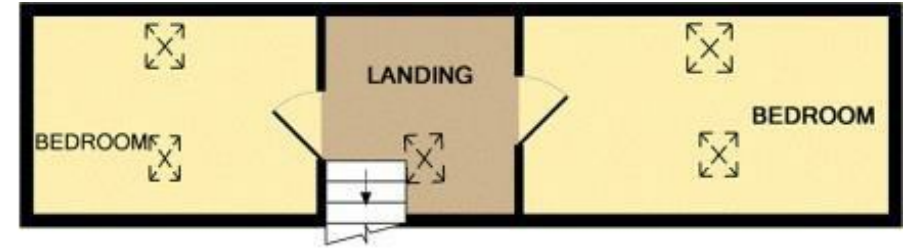

1ST FLOOR

Whilst every attempt has been made to ensure the accuracy of the floor plan contained here, measurements of doors, windows, rooms and any other items are approximate and no responsibility is taken for any error, omission, or mis-statement. This plan is for illustrative purposes only and should be used as such by any prospective purchaser. The services, systems and appliances shown have not been tested and no guarantee as to their operability or efficiency can be given.  
 Made with Metropix ©2018



